

## FS-60-RD Centrifugal Feeder

### Designed for Quiet, High Speed Feeding



#### Product Overview:

Shibuya Hoppmann's standard FS-60 scallop feeder is designed to feed and orient bottles and other cylindrical parts with the use of urethane scallops. Parts are radially oriented and gently qualified in the scallop pockets by means of sweeps, wipers, pneumatic and/or electric devices depending on specific product characteristics. Oriented parts are discharged and carried away by various downstream in-line devices.

#### Product Specifications:

	ANSI	Metric
A. Outside Diameter	93"	2362mm
B. Frame Height	47" ± 1.5"	1194mm ± 40mm
C. Discharge Height	36" ± 2"	914mm ± 51mm
D. Bowl Outside Diameter	69.31"	1761mm
E. Bowl Inside Diameter	58"	1473mm
F. Rim Width	5.5"	140mm
G. Bowl Depth	9.13"	232mm

#### Standard Models:

	FS601RLDSA	FS601RLASA
Part Number		
Motor Style	DC	AC
Motor Voltage	90V	208-230/460V
Horsepower	3/4 hp	560 W

#### Standard Features:

- All stainless steel construction
- FDA/USDA approved heavy gauge ABS plastic disc
- Teflon hard-coat finished aluminium bowl, predrilled for scallop mounting
- Air clutch
- Hinged polycarbonated cover with safety interlocks
- Backup ring
- Panel mount controller card

#### Available Options:

- Washdown motors
- Urethane scallop kit
- NEMA 1 encased controller

#### Required Accessories:

FS Series Scallop Kit ..... FS60SCALXX  
*(includes segment plates and a set of scallops. Contact Shibuya Hoppmann for more information).*

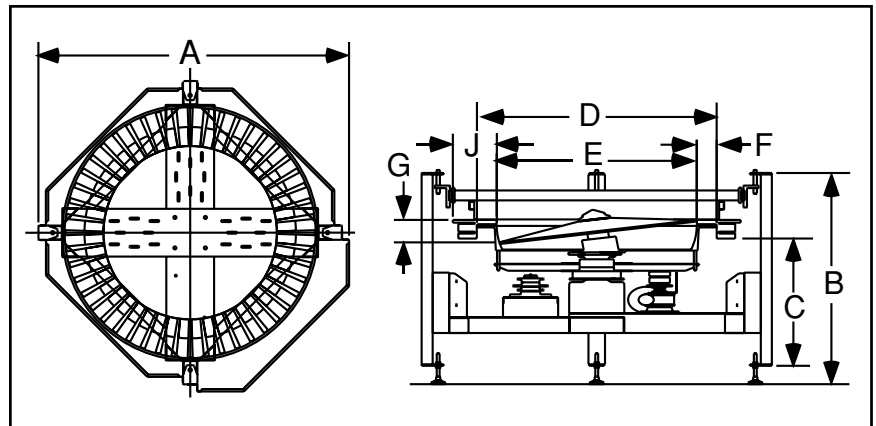

*Shibuya Hoppmann strives to improve its products and reserves the right to change or discontinue specifications & designs shown in this brochure without notice and without incurring obligation.*

11/06